

<p>A 54sets</p> <p>A1 A2</p>	<p>B 20pcs</p> <p>40*8</p>	<p>C 4pcs</p>	<p>D 4pcs</p> <p>35*3.5mm</p>	<p>E 32pcs</p> <p>14*3.5mm</p>	<p>F 1set</p> <p>F1</p> <p>F2</p>	<p>G 40pcs</p>	<p>H 8pcs</p>
-------------------------------------	-----------------------------------	----------------------	--------------------------------------	---------------------------------------	--	-----------------------	----------------------

1

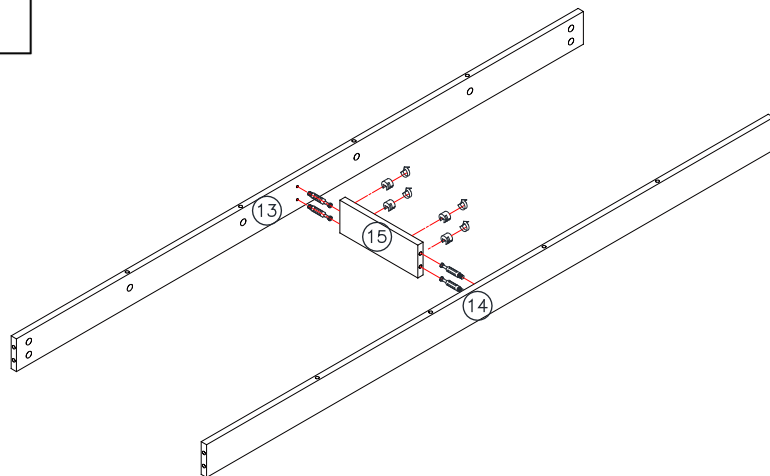

A1*4 A2*4

2

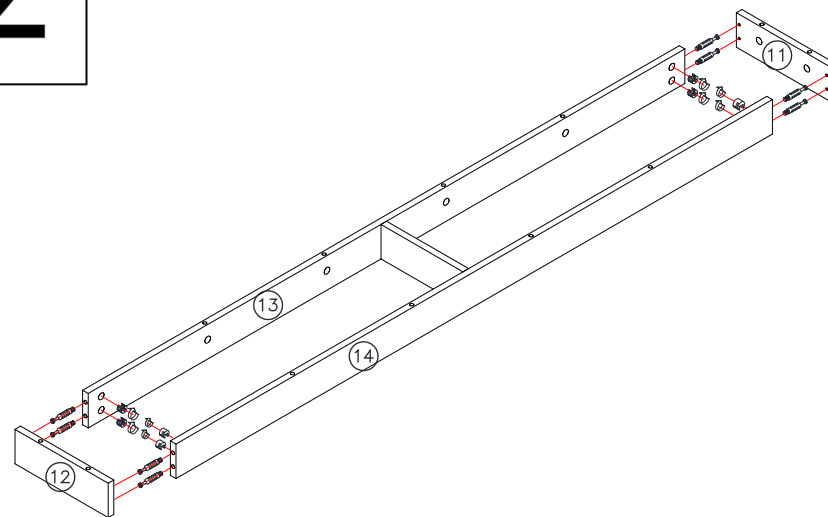

A1*8 A2*8

3

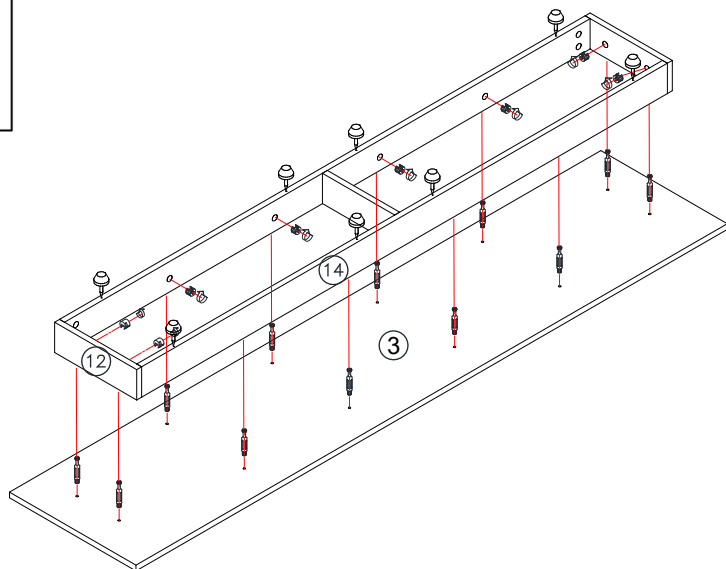

A1*12 A2*12 H*8

4

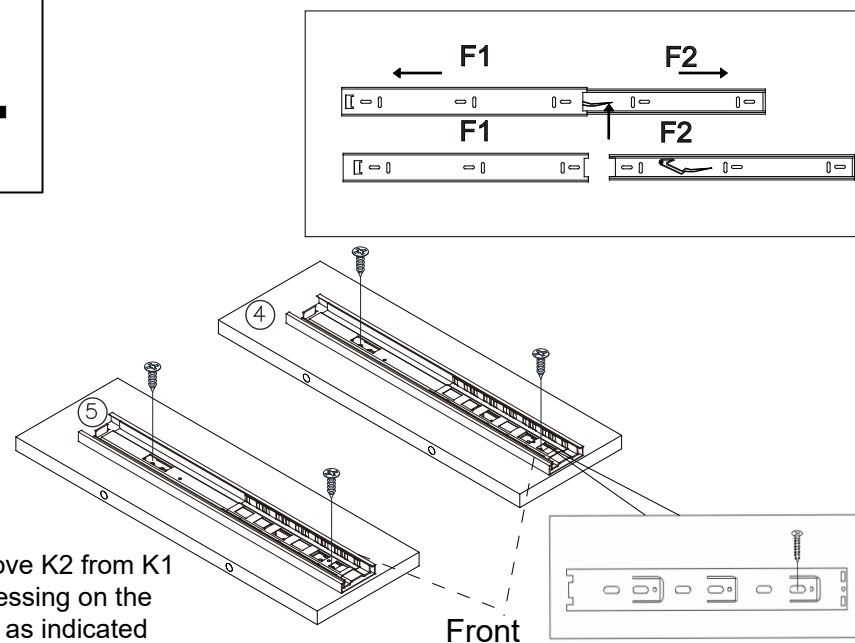

Remove K2 from K1
by pressing on the
catch as indicated
and sliding it out.

Front

F1*2 E*4

5

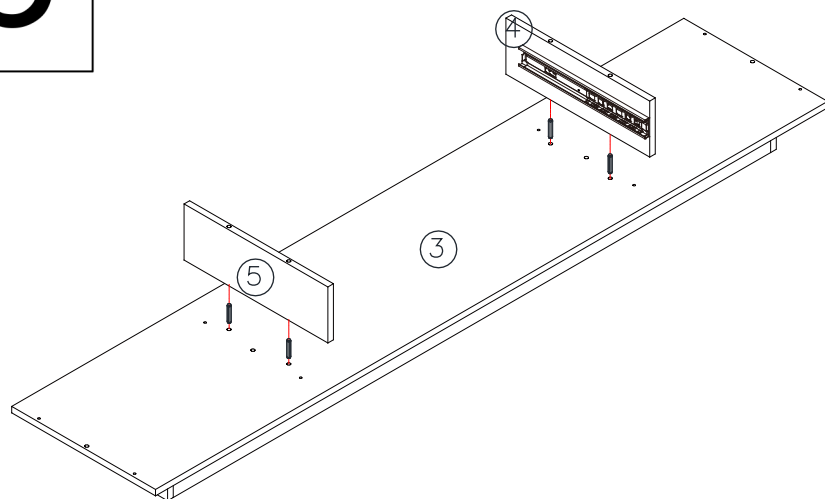

B*4

6

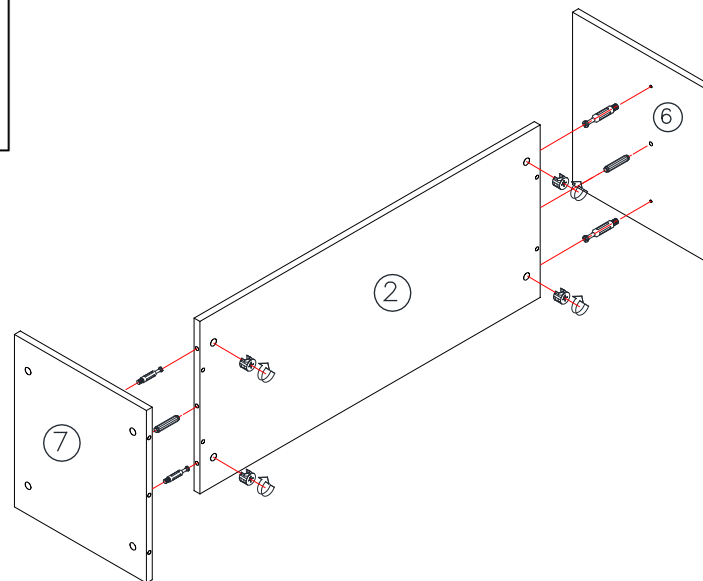

A1*4 A2*4 B*2

7

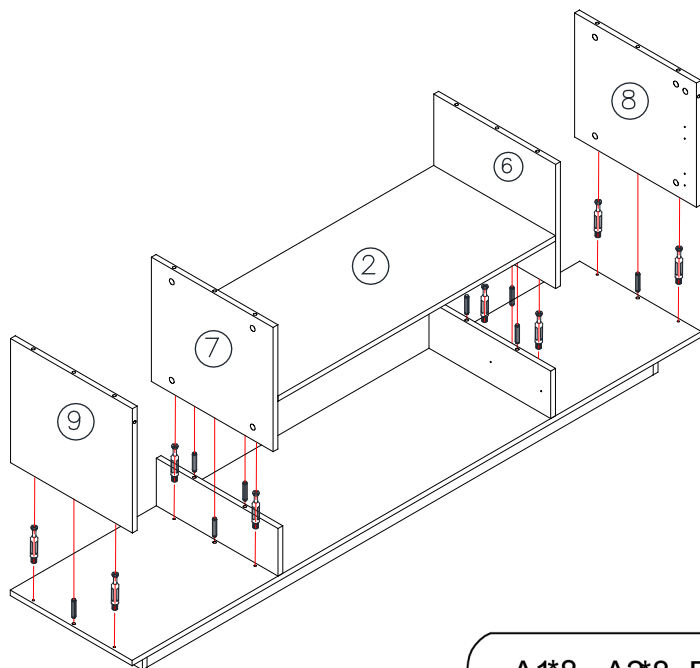

A1*8 A2*8 B*8

8

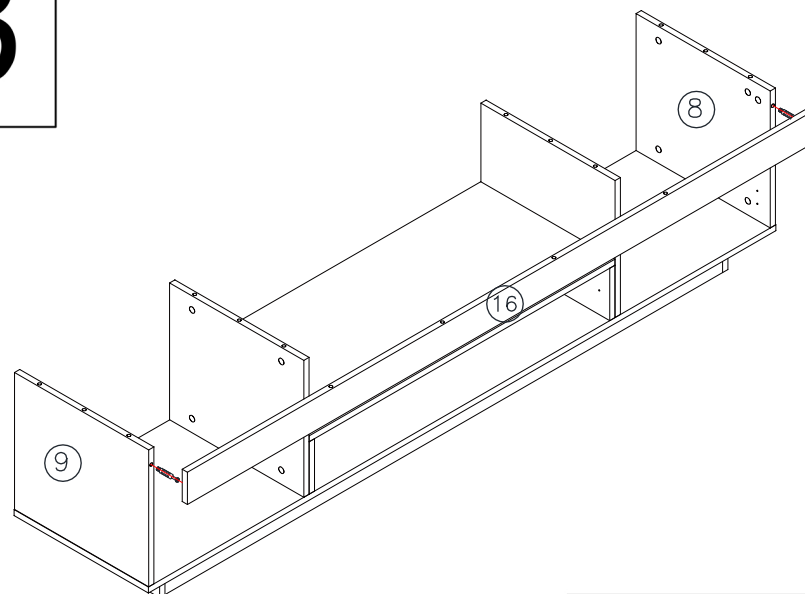

A1*2 A2*2

9

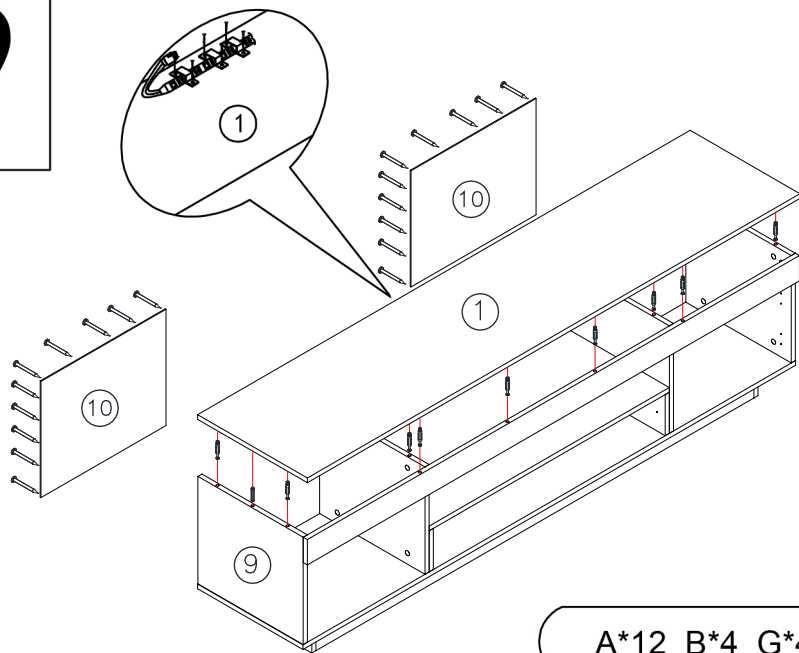

A*12 B*4 G*40

10

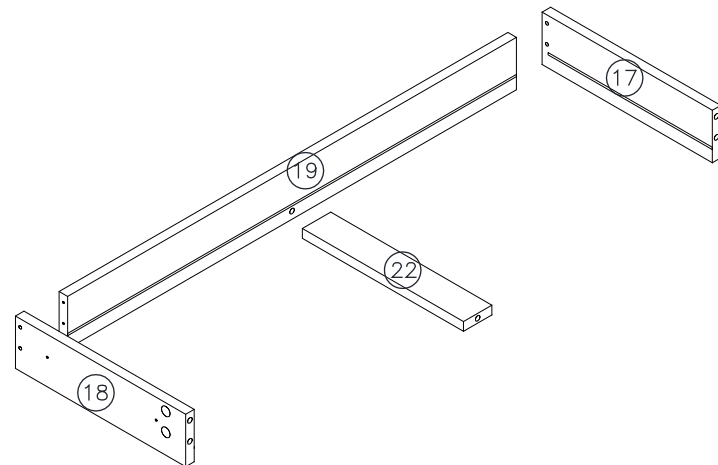

D*4 B*1

11

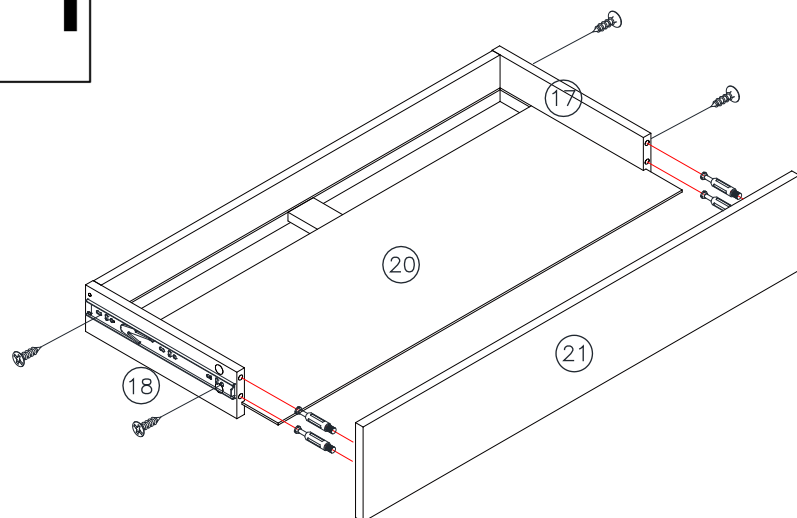

A*4 B*1 F2*2 E*4

12

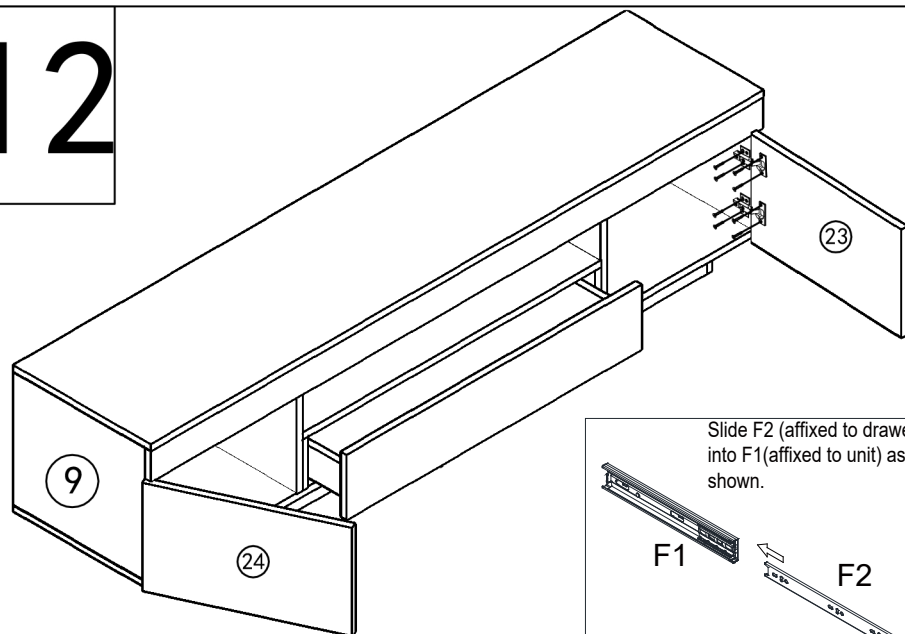

C*4 E*24

Slide F2 (affixed to drawer)
into F1 (affixed to unit) as
shown.

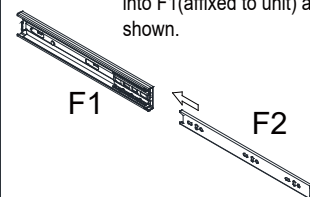

13

Hinge Adjustment

If the doors do not appear square or aligned, loosen or tighten the appropriate screws on each case hinge as illustrated.

1) Side to side adjustment:
Loosen screw A, adjust gap with screw B and re-tighten screw A.

2) Depth adjustment:
Loosen screw A, push hinge arm forwards or backwards, re-tighten screw A and screw B with a 1/4 turn clockwise.

3) Height adjustment:
Loosen screw C, adjust door height and re-tighten screw C.

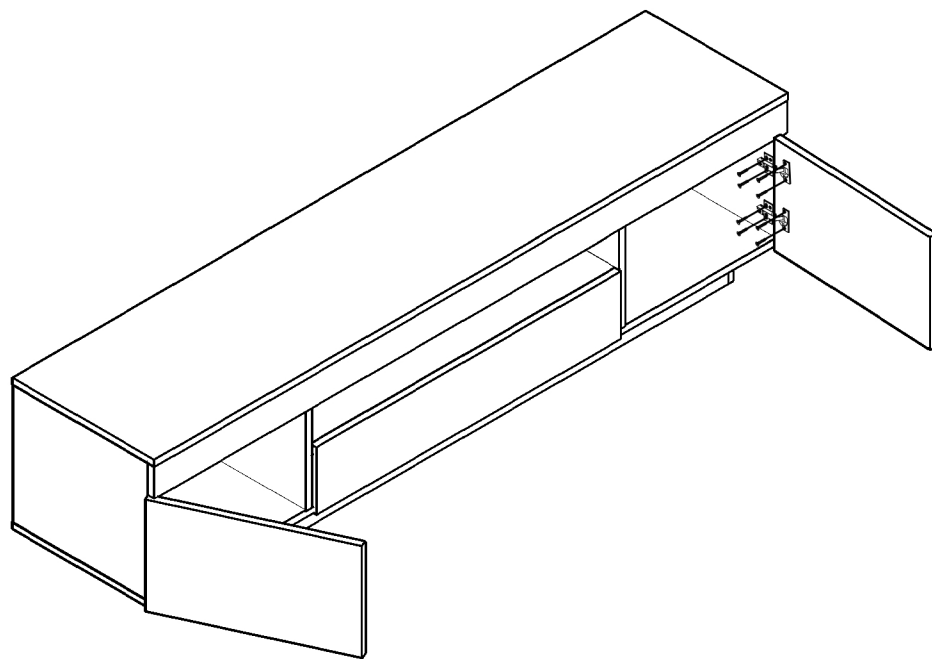
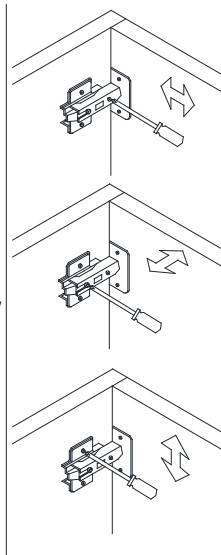

C*4 E*24

14

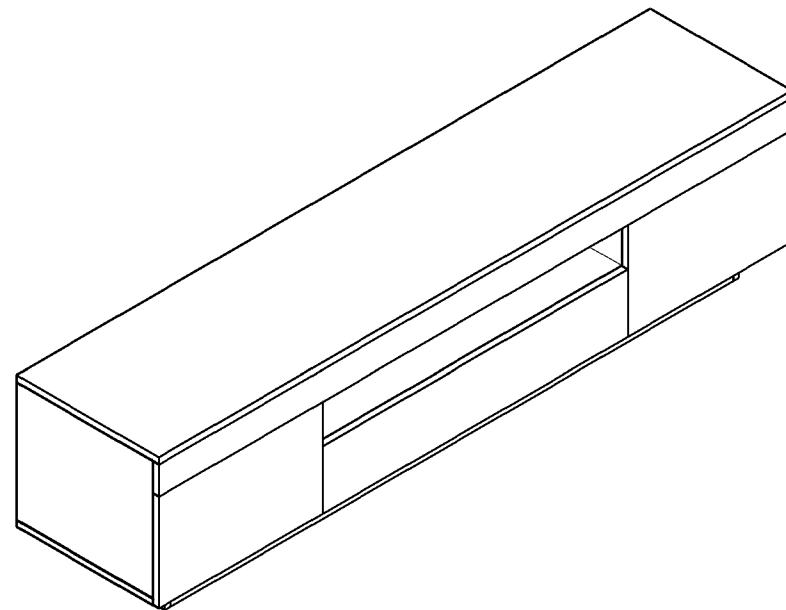

LED LIGHTS TROUBLESHOOTING

If the LED lights are not working successfully, please check the following:

1. Check the facing of the connectors and ensure that they are as shown in the illustration.
2. Check the remote controller. Remove the plastic film before use.
3. Make sure that the remote controller is within the range of the receiver, and that the transmission signal is not obstructed.

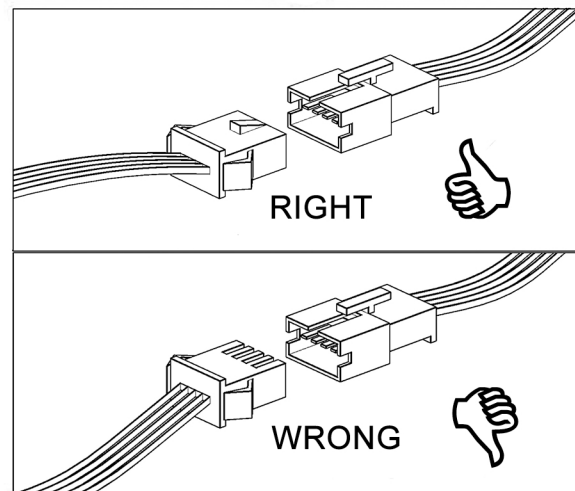

Check the facing of the connectors and ensure that they are aligned correctly.

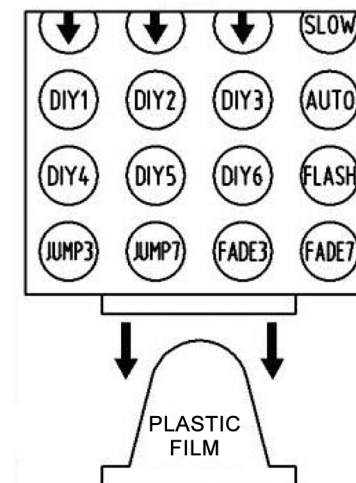

Remove the plastic film from the remote controller.

REMOTE CONTROLLER OPERATING INSTRUCTIONS

SPECIFICATIONS

Working temperature:	-20° to 60°C
Product dimensions:	62mm (L) x 35mm (W) x 23mm (H)
Net weight:	50g
Output:	Three CMOS drain-open output
Maximum load current:	2A per colour
Supply voltage:	DC12V

CONTROL

The function of each button on the remote controller are as shown in the table below:

Brightness + (speed up)	Brightness + (speed down)	Off	On
Static red	Static green	Static blue	Static white
Static orange	Static pea green	Static dark blue	7-colour jump change
Static dark yellow	Static cyan	Static brown	All fade out and fade in
Static yellow	Static light blue	Static pink	7-colour fade change
Static straw yellow	Static sky blue	Static purple	3-base colour jump

CIRCUIT DIAGRAM

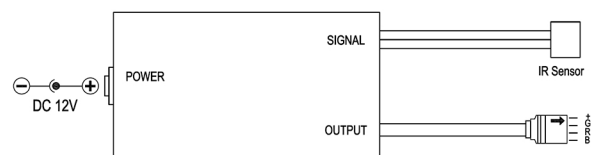

WARNINGS

1. The supply voltage of the product is DC12V. Never connect to DC24V or AC220V.
2. Never connect two wires directly to prevent a short circuit.
3. Ensure that the wire connections are connected correctly as per the circuit diagram above.
4. This product as a one-year warranty against manufacturing defects but not for damages due to incorrect use or current overload.

ATTENTION

This product contains a button battery.

If swallowed, a lithium button battery can cause severe or fatal injuries within two hours.

Keep battery out of reach of children.

If you think the battery may have been swallowed or placed inside any part of the body, seek medical attention immediately.