

# ELECTRIC HEATED TOWEL RAIL

## Instruction Manual



Model: HTW-ALU-W140-7B

Size: 500\*110\*810mm

Rating: 220-240V~.50/60Hz.140W

IP Degree: IP X4



### IMPORTANT SAFEGUARDS

1. Please read all instructions before using this product. And keep this safety instructions for your future reference.
2. Keep away from Children and disable persons when using the product.
3. Always unplug the product when not in use.
4. Stop using the product when the plug or cord is damaged. Should be

replaced or repaired by the professionals from the maintenance department or similar department from manufacturer.

5. For household use only. Do not use outdoors.
6. Never put the product into water in the bath or other water containers.
7. Do not use the power cord under the floor mats, the chute or carpet to avoid the danger of trip hazard.
8. Do not unplug the product by power cord, should hold the plug, not the cord.
9. Do not place any objects inserted into vents and exhaust ports, as it may cause an electric shock, fire and damage the product.
10. Do not use it in areas where gasoline, paints, or flammable liquids are used or stored.
11. Use this product strictly as description in this manual to avoid the cause of fire, electric shock, or injury to persons.
12. Children should be supervised to ensure that they do not play with the appliance.
13. Children, Elderly people with limited mobility, people with physical, sensory or mental impairments and lack of experience and knowledge should be using the product under the care or guidance by person responsible for their safety.
14. Do not wrap the product by the towels, quilts when in use. Just lay the towels and quilts on the product.

### WARNING

This appliance is intended only for drying textiles washed in water. In order to avoid a hazard for very young children, this appliance should be installed so that the lowest heated rail is at least 600 mm above the floor. The towel rail is to be installed so that switches and other controls cannot be touched by a person in the bath or shower. THE TOWEL WARMER IS ONLY ALLOWED TO BE INSTALLED at A DISTANCE OF at least 0.6 m from basins, bathtubs and showers. Keep electrical appliances out of reach from children or infirm persons. Do not let them use the appliances without supervision. Do not connect the plug into a socket-outlet which is exposed to splashing. The Towel Warmer shall not be connected to covered socket outlets. This warmer is not intended for use with an extension cord. Plug the cord directly into an appropriate wall receptacle. The warmer must not be located immediately below a socket-outlet. To provide continued protection against risk of electric shock, connect to properly grounded outlets only. Please unplug the warmer while not in use or before cleaning. Do not immerse in water.

## INSTRUCTION MANUAL

This Towel Warmer is intended for use in bathrooms or laundry areas.

READ THE INSTRUCTIONS CAREFULLY BEFORE OPERATING

### SPECIFICATION

Power Source : 220-240 V AC, 50/60Hz, Class I

Rating Power Input :140W

Unit Size : 81×50×11 (H x W x D) cm

### OPERATING INSTRUCTIONS

#### POWER ON/OFF SWITCH

1. Press the switch at (I) position, the power indicator light up and this heater start to work.

Correct Disposal of this product	
	This marking indicates that this product should not be disposed with other household wastes throughout the EU. To prevent possible harm to the environment or human health from uncontrolled waste disposal, recycle it responsibly to promote the sustainable reuse of material resources. To return your used device, please use the return and collection systems or contact the retailer where the product was purchased. They can take this product for environmental safe recycling.

2. Press the switch at [O] position, the power indicator light off and this heater finish working.

### OPERATION

1. Please read the installation instruction carefully to understand how to install your towel warmer.
2. Make sure the installation is completed.
3. Press the power switch to [OFF] position.(i.e. Power indicator light is off).
4. Plug the power cord into an electrical outlet.
5. After connecting to suitable power supply, press the power ON/OFF switch, the power indicator lights up and then the warmer starts the heating work.

### MAINTENANCE

If the power cord is damaged, it must be replaced by the professionals from the maintenance department or similar department from manufacturer to avoid the danger.

### CLEANING

1. Before cleaning, please unplug the product and let it cool down.
2. Do not put the product, power cord and plug into the water. Keep the cord dry.
3. Never clean the product with alcohol or solvent-based cleansers.
4. Please clean the surface by wet towel first and then dry it with a soft cotton cloth. Please NOTE: Do not use a metal ball or a rough cloth to wipe the towel

rack, it will scratch the surface of the product.

5. Please do not use alcohol or solvents on plastic components, it will cause the cracking and ageing of these parts.

### INSTALLATION INSTRUCTION

1. Choose a right place to fix the four corner of the electric heated towel rail. Mark 4 circles of each corner. Then find the center of the 4 mark circles to drill holes.

2. Insert the wall plug into the 4 holes as illustrate at right.

3. Put the self-tapping screws through the center hole of the clubfoot and fix it to the wall.

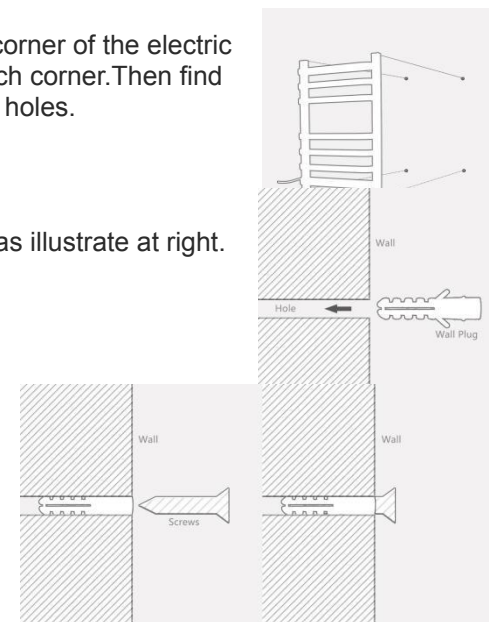

4. Fix 4 feet to the clubfeet, screw up the feet with a wrench until totally fixed.

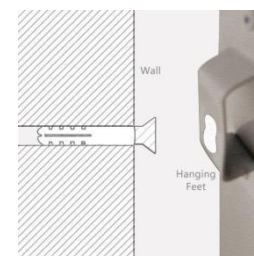

### WARRANTY INFORMATION

The manufacturer provides warranty in accordance with the legislation of the customer's own country of residence, with a minimum of 1 year (Germany: 2 years), starting from the date on which the appliance is sold to the end user.

The warranty only covers defects in material or workmanship.

The repairs under warranty may only be carried out by an authorized service centre. When making a claim under the warranty, the original bill of purchase (with purchase date) must be submitted.

The warranty will not apply in cases of:

- Normal wear and tear
- Incorrect use, e.g. overloading of the appliance, use of non-approved accessories
- Use of force, damage caused by external influences
- Damage caused by non-observance of the user manual, e.g. connection to an unsuitable mains supply or non-compliance with the installation instructions
- Partially or completely dismantled appliances