

# ASSEMBLY INSTRUCTIONS

PAGE: 1/4

MODEL : VOGUE-ST 5050



Before you begin, please follow assembly instructions carefully, then follow them step by step.

Read instruction carefully . See Furniture Parts list and Hardware List for guidance . Be sure you have all parts before you start assembling .  
Place and assemble furniture on a clean flat soft surface , such as carpet or rug to prevent being scratched .

PART LIST		QTY
1	TOP PANEL	1 PC
2	BOTTOM PANEL	1 PC
3	SIDE PANEL (L)	1 PC
4	SIDE PANEL (R)	1 PC
5	BACK PANEL	1 PC
6	DRAWER FRONT	1 PC
7	DRAWER BACK	1 PC
8	DRAWER SIDE	2 PCS
9	DRAWER BOTTOM	1 PC
10	METAL SIDE (L)	1 PC
11	METAL SIDE (R)	1 PC
12	METAL BONE	2 PCS

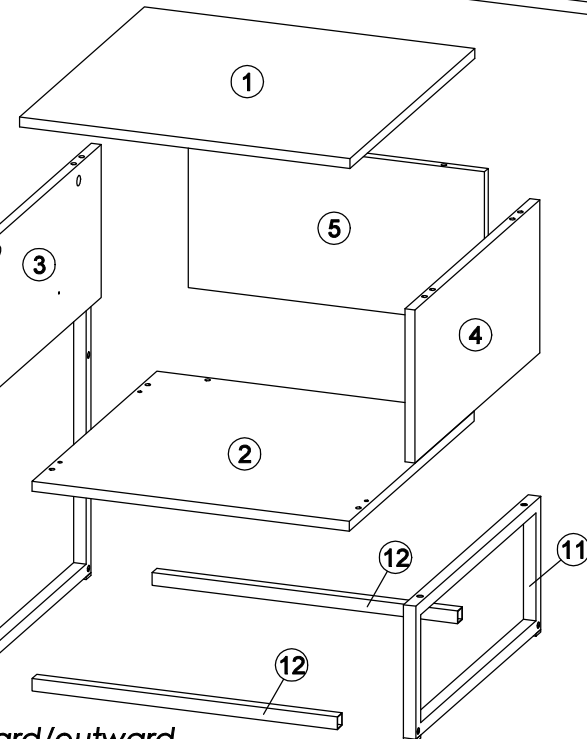
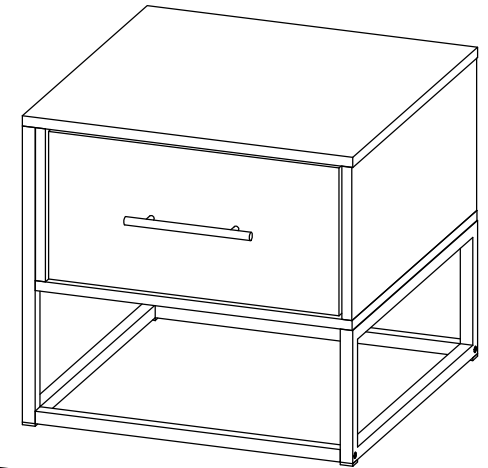
HARDWARE					
A	MINI FIX	A1	A2	A3	4 SETS
B	M8 X 30MM WOOD DOWEL				12 PCS
C	M6 X 50MM CSK CAP WOOD SCREW				4 PCS
D	ALLEN KEY M4				1 PC
E	M3.5 X 16MM C.B SCREW				12 PCS
F	M4 X 38MM C.B SCREW				8 PCS
G	M4 X 45MM C.B SCREW				2 PCS
H	5/8 NAIL				8 PCS
I	JCBC SCREW M6 X 30MM				5 PCS
J	JCBC SCREW M6 X 40MM				4 PCS
K	HANDLE 12812				1 PC
L	14" DRAWER SLIDE	L1 (L/R)	L2 (L/R)		1 SET



SELF-PREPARED TOOLS: Tools below are NOT included in package.	
 SCREWDRIVER	 HAMMER

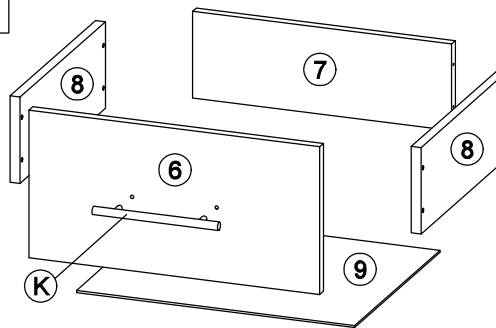

## Reminder:

Please ensure that all surfaces and edges with colours/laminations are facing forward/outward.

# ASSEMBLY INSTRUCTIONS

PAGE: 2/4

## MODEL : VOGUE-ST 5050

### STEP 1

- Insert hardware **A1** onto panel **(3)** and **(4)**.  
(Repeat 4 times.)
- Insert hardware **A2** onto panel **(1)**.  
(Repeat 4 times.)
- Insert hardware **B** onto panel **(3)**, **(4)** and **(5)**.  
(Repeat 12 times.)

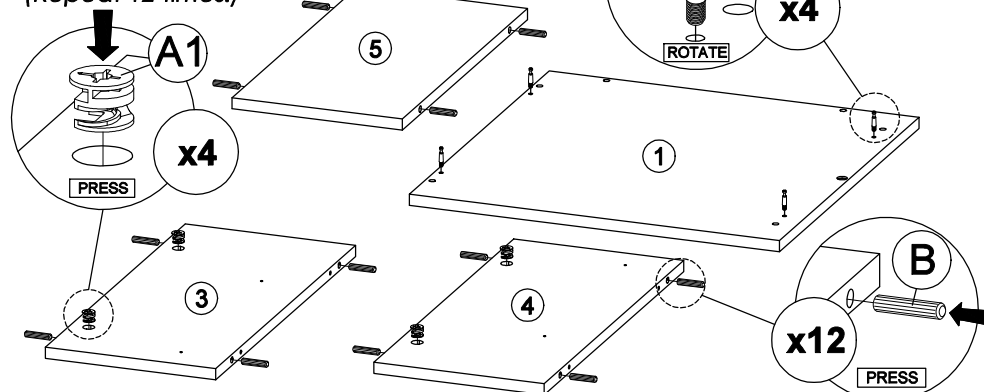

\* Ensure the arrows on hardware **A1** point towards mounting positions.

### STEP 2

- Fix hardware **L1 (L)** into panel **(3)** with hardware **E**.  
(Repeat 3 times for each hardware.)

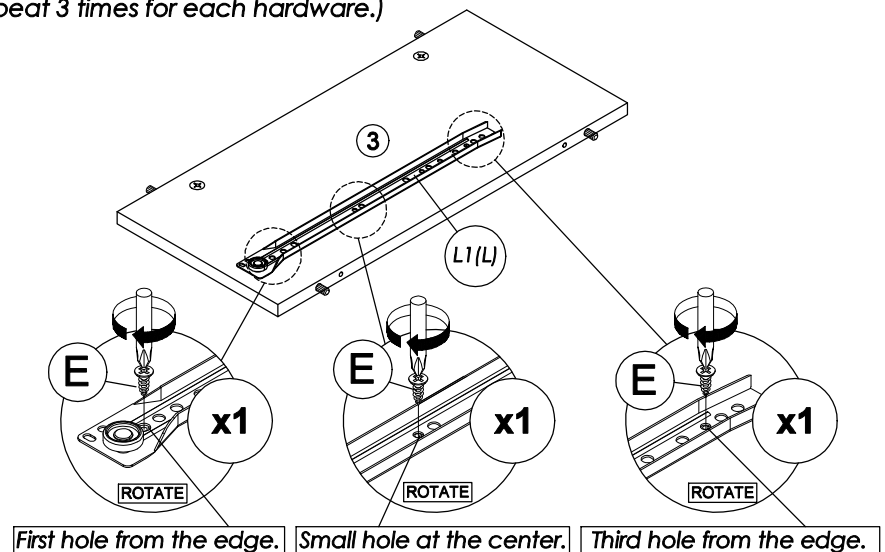

### STEP 3

- Fix hardware **L1 (R)** into panel **(4)** with hardware **E**.  
(Repeat 3 times for each hardware.)

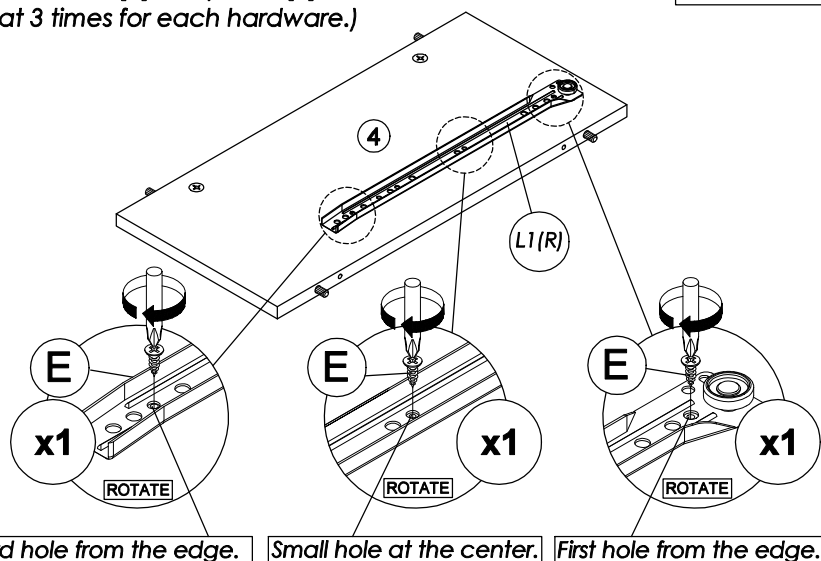

### STEP 4

- Attach panel **(3)**, **(4)** and **(5)** to panel **(1)**.
- Insert all hardware **A2** into **A1**.
- Rotate all **A1** until tight.
- Apply **A3** onto all **A1**.  
(Repeat 4 times.)

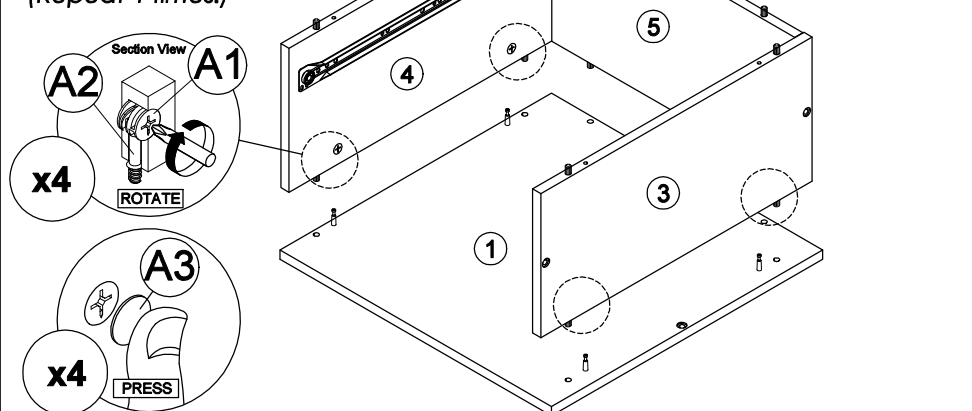

\* In this step hardware **A1**, **A2** and **B** are pre-inserted.

# ASSEMBLY INSTRUCTIONS

PAGE: 3/4

MODEL : VOGUE-ST 5050

## STEP 5

- Connect panel (2) to panel (3) and (4) by using hardware C and D.  
(Repeat 4 times.)

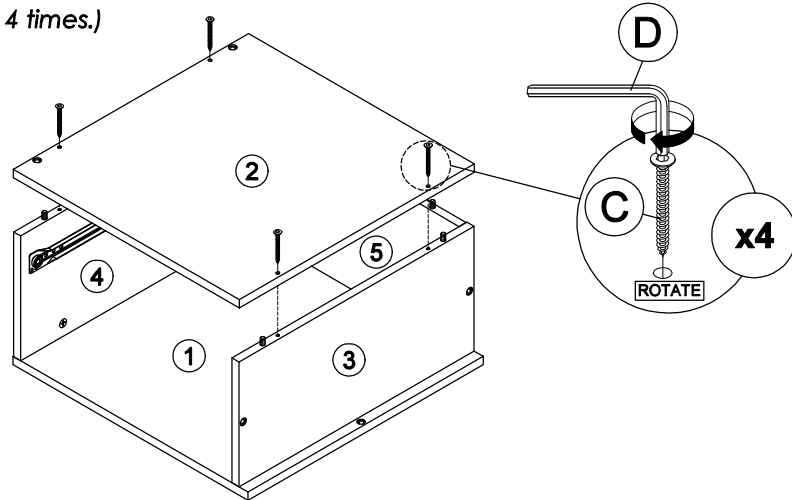

\* In this step hardware B are pre-inserted.

## STEP 7

- Connect Metal Side (10) and (11) to panel (1), (2) and (3) by using hardware D and I.  
(Repeat 5 times.)

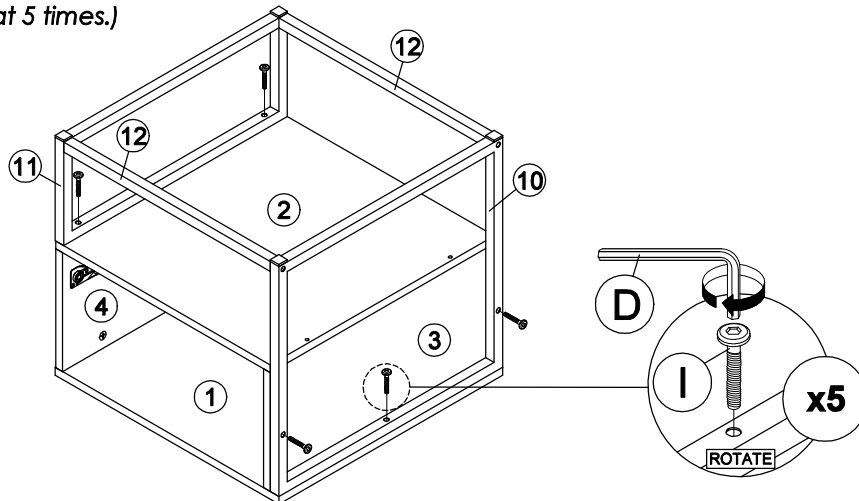

## STEP 6

- Connect Metal Side (10) and (11) to Metal Bone (12) by using hardware D and J.  
(Repeat 4 times.)

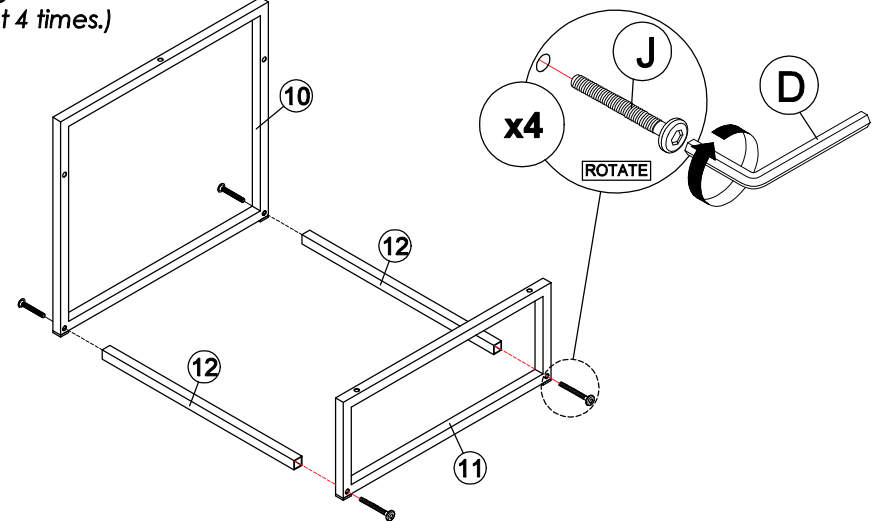

## STEP 8

- Assemble panel (8) with panel (6) and (7) by using hardware F.  
(Repeat 8 times.)

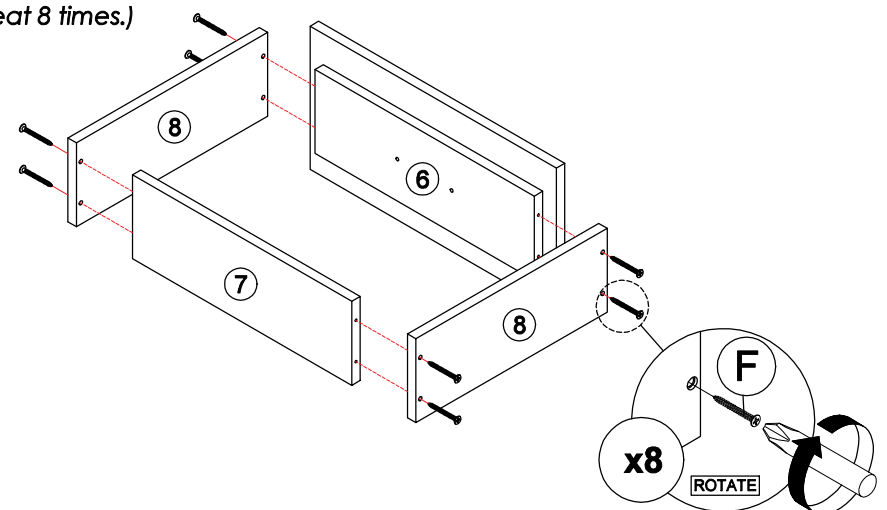

# ASSEMBLY INSTRUCTIONS

PAGE: 4/4

## MODEL : VOGUE-ST 5050

### STEP 9

- Assemble panel (9) to entire body with hardware H. (Repeat 8 times.)

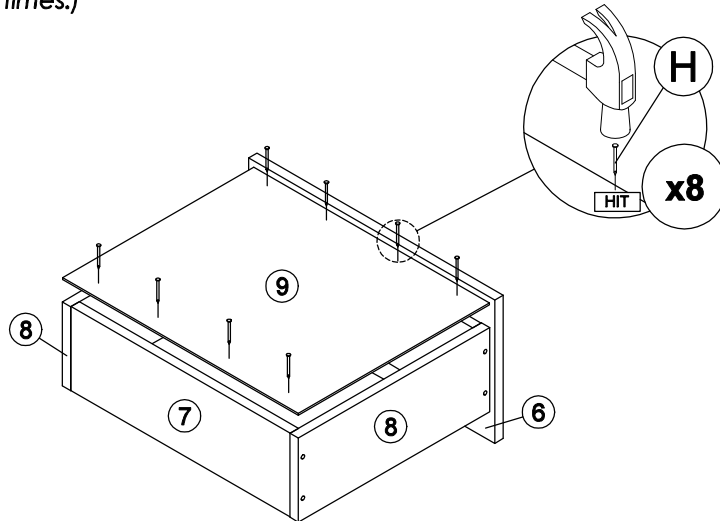

### STEP 10

- Assemble hardware L2 (L/R) to panel (9) by using hardware E. (Repeat 3 times for each hardware.)

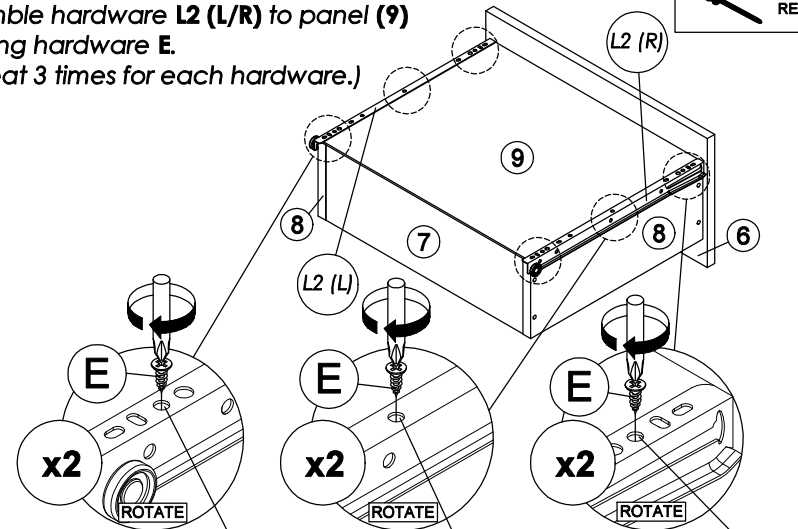

Third hole from the edge.

Hole at the center.

Third hole from the edge.

\*Hardware L2 (L/R) shall be leaning against panel (6) when assembling.

### STEP 11

- Fix hardware K onto panel (6) by using hardware G. (Repeat 2 times.)

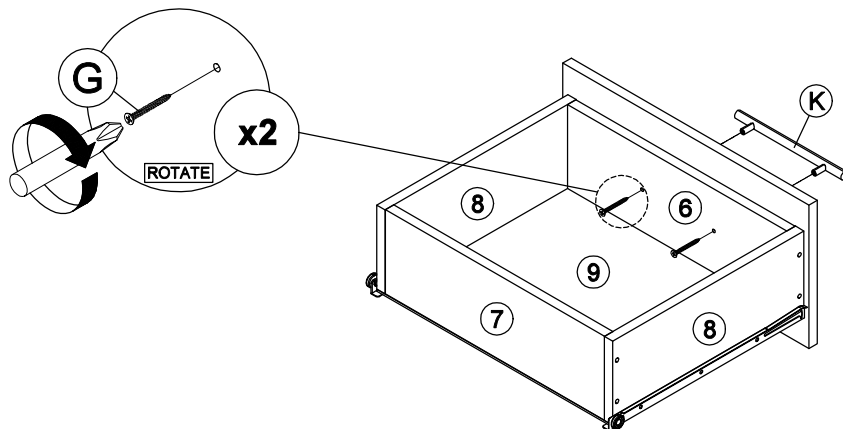

### STEP 12

- Put all the drawer in place along the drawer slides.

