

# ASSEMBLY INSTRUCTIONS

Before you begin, please follow assembly instructions carefully, then follow them step by step.

Read instruction carefully . See Furniture Parts list and Hardware List for guidance . Be sure you have all parts before you start assembling . Place and assemble furniture on a clean flat soft surface , such as carpet or rug to prevent being scratched .

PART LIST		QTY
1	TOP PANEL	1 PC
2	BOTTOM PANEL	1 PC
3	SIDE PANEL (L)	1 PC
4	SIDE PANEL (R)	1 PC
5	BONE PANEL	3 PCS
6	BACK PANEL	1 PC
7	APRON BONE (FRONT)	1 PC
8	APRON BONE (BACK)	1 PC
9	APRON BONE	2 PCS
10	DRAWER FRONT	3 PCS
11	DRAWER BACK	3 PCS
12	DRAWER SIDE	6 PCS
13	DRAWER BOTTOM	3 PCS

HARDWARE			
A	MINI FIX	A1  A2  A3	8 SETS
B	M8 X 30MM WOOD DOWEL		24 PCS
C	M6 X 60MM CSK CAP WOOD SCREW		4 PCS
D	ALLEN KEY M4		1 PC
E	M3.5 X 16MM C.B SCREW		44 PCS
F	M4 X 38MM C.B SCREW		32 PCS
G	5/8 NAIL		52 PCS
H	5/8 PVC NAIL LEG		4 PCS
I	14" DRAWER SLIDE	11 (L/R)  12 (L/R)	3 SETS
J	ONE HOLE L BRACKET (2MM)		4 PCS

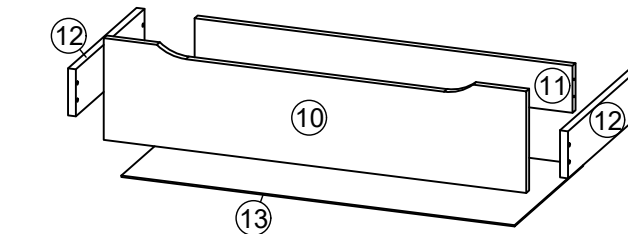
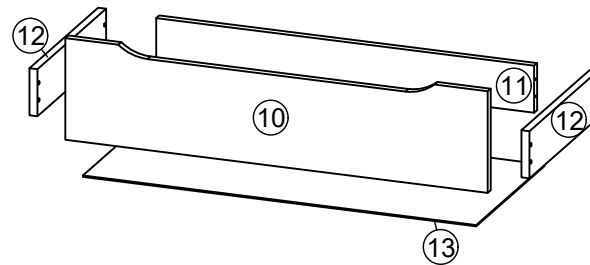
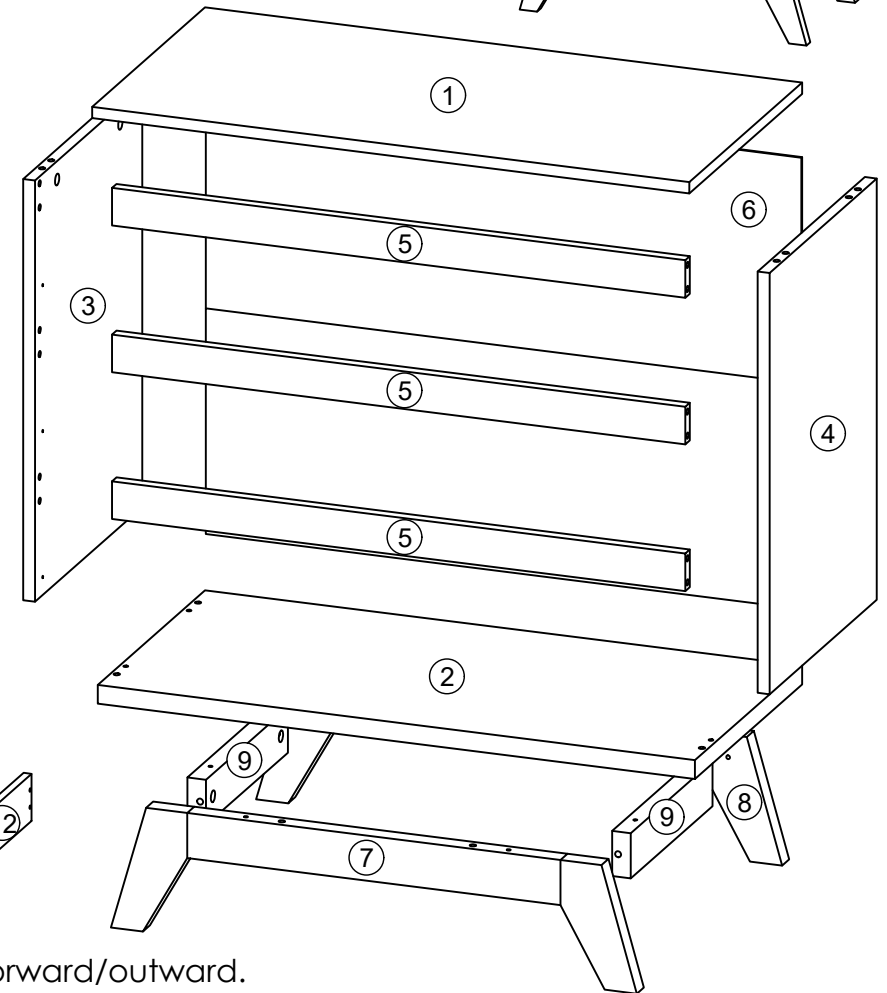
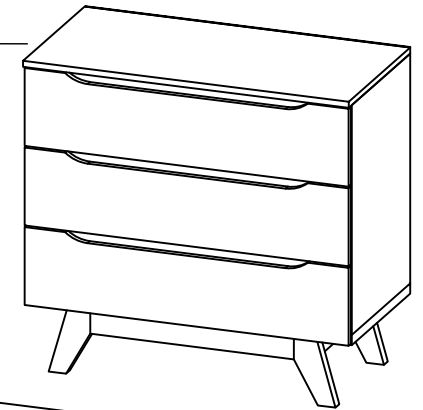

**SELF-PREPARED TOOLS:** Tools below are NOT included in package.

SCREWDRIVER	HAMMER
-------------	--------

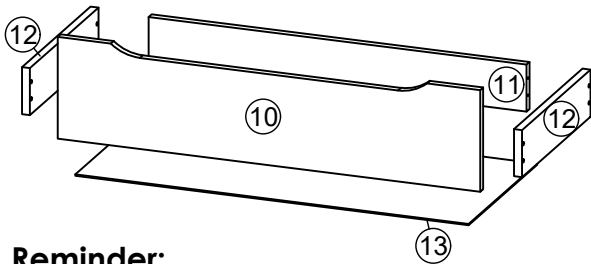

**Reminder:**

Please ensure that all surfaces and edges with colours/laminations are facing forward/outward.

# ASSEMBLY INSTRUCTIONS

PAGE: 2/5

# MODEL : HMZ-FN-DC-7780-WT

## STEP 1

- Insert hardware **A1** onto panel **(3)**, **(4)** and **(9)**.  
(Repeat 8 times.)
- Insert hardware **A2** onto panel **(1)**.  
(Repeat 4 times.)
- Insert hardware **B** onto panel **(3)** and **(4)**.  
(Repeat 8 times.)

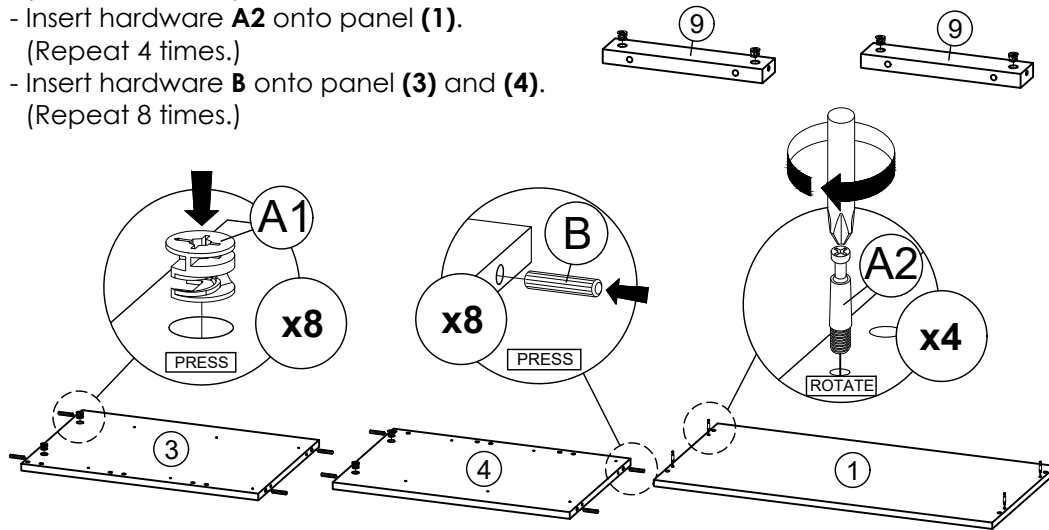

\* Ensure the arrows on hardware **A1** point towards mounting positions.

## STEP 3

- Fix hardware **I1 (L/R)** into panel **(3)** and **(4)** with hardware **E**.  
(Repeat 3 times for each hardware.)

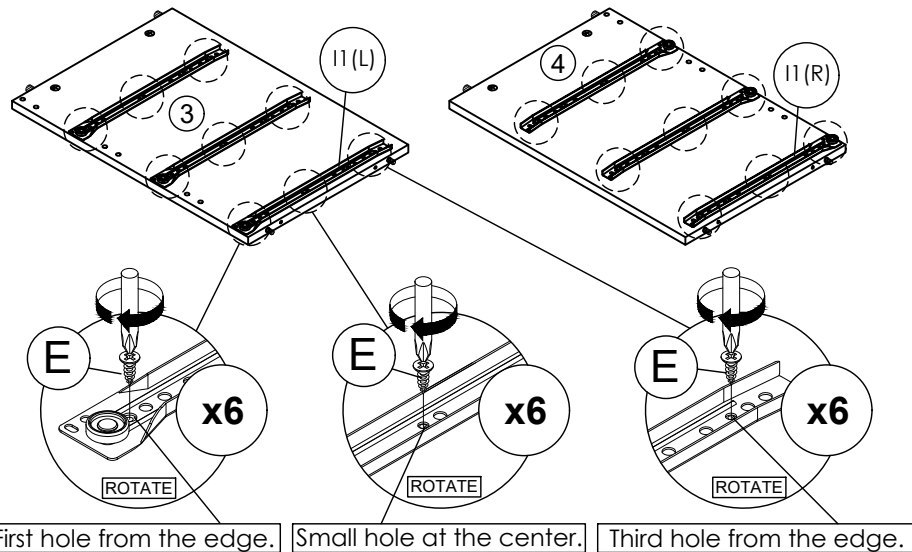

First hole from the edge.

Small hole at the center.

Third hole from the edge.

## STEP 2

- Assemble hardware **J** onto two of the panel **(5)** with hardware **E**.  
(Repeat 4 times.)
- Insert hardware **A2** onto panel **(7)** and **(8)**.  
(Repeat 4 times.)
- Insert hardware **B** onto panel **(5)**, **(7)** and **(8)**.  
(Repeat 16 times.)

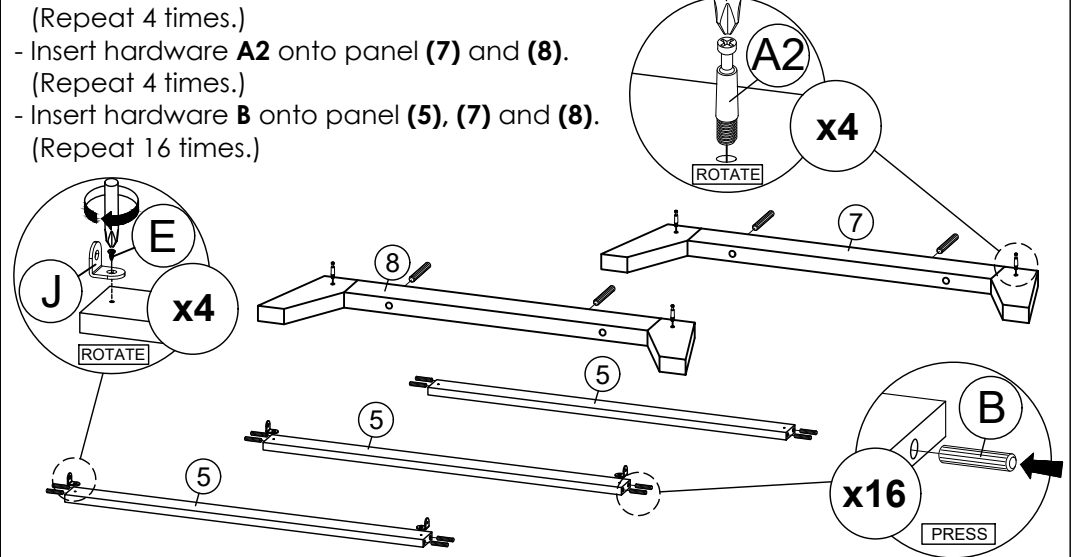

## STEP 4

- Attach panel **(3)** and **(4)** to panel **(5)**.  
(Repeat 3 times.)
- Assemble hardware **J** from panel **(5)** to panel **(3)** and **(4)** with hardware **E**.  
(Repeat 4 times.)

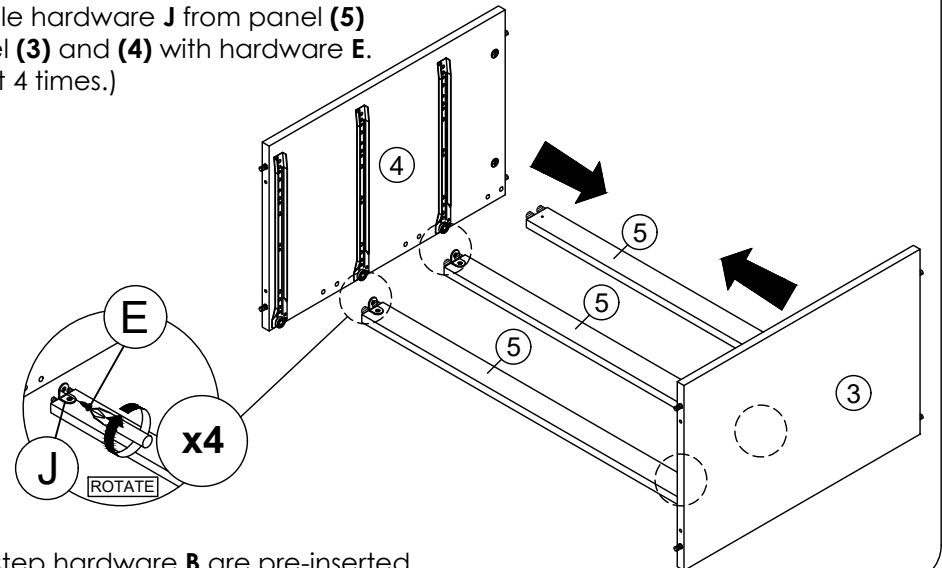

\* In this step hardware **B** are pre-inserted.

# ASSEMBLY INSTRUCTIONS

PAGE: 3/5

MODEL : HMZ-FN-DC-7780-WT

## STEP 5

- Attach panel (1) to panel (3) and (4).
- Insert all hardware A2 into A1.
- Rotate all A1 until tight.
- Apply A3 onto all A1.
- (Repeat 4 times.)

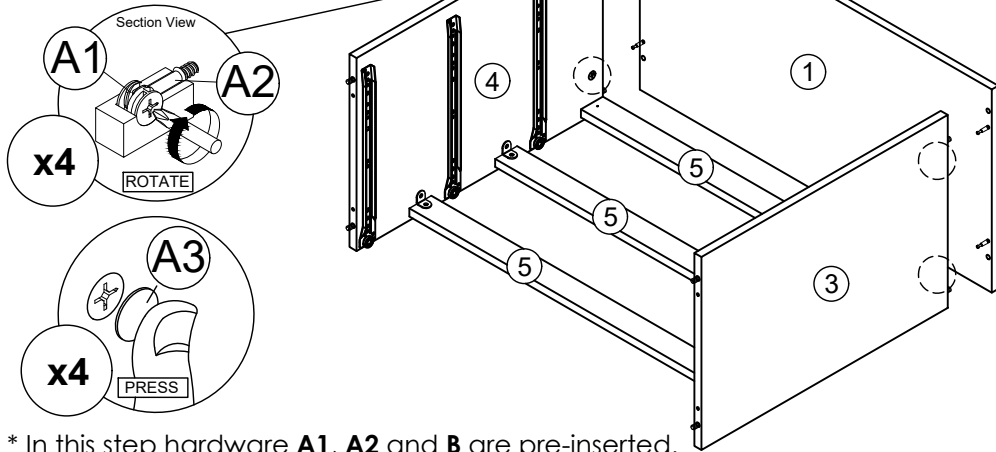
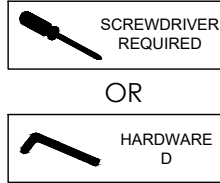

\* In this step hardware A1, A2 and B are pre-inserted.

## STEP 6

- Connect panel (2) to panel (3) and (4) by using hardware C and D.
- (Repeat 4 times.)

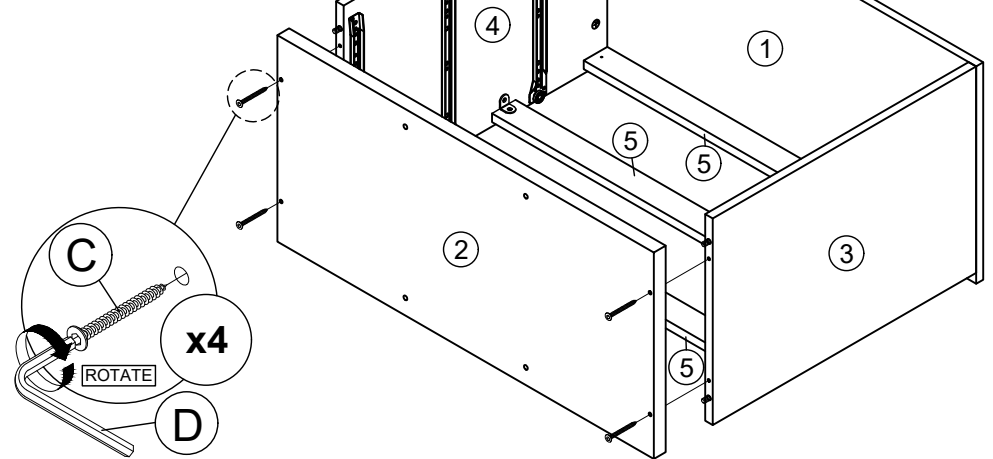

\* In this step hardware B are pre-inserted.

## STEP 7

- Assemble panel (6) to entire body with hardware G.
- (Repeat 16 times.)

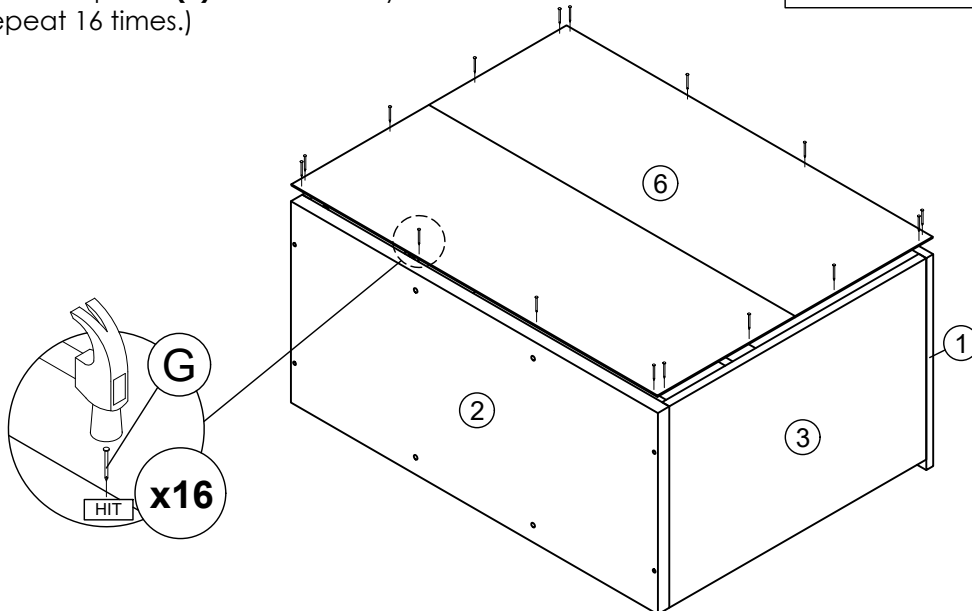

## STEP 8

- Attach panel (7) and (8) to panel (9).
- Insert all hardware A2 into A1.
- Rotate all A1 until tight.
- Apply A3 onto all A1.
- (Repeat 4 times.)

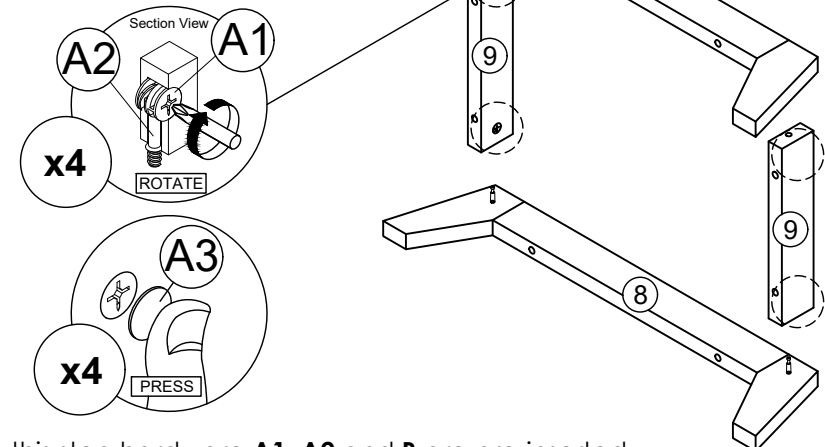
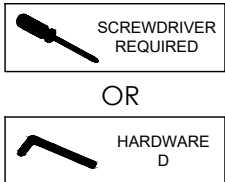

\* In this step hardware A1, A2 and B are pre-inserted.

# ASSEMBLY INSTRUCTIONS

# MODEL : HMZ-FN-DC-7780-WT

## STEP 9

- Hit hardware **H** into bottom of panel **(7)** and **(8)**.  
(Repeat 4 times.)
- Assemble panel **(7)**, **(8)** and **(9)** with panel **(2)** by using hardware **F**.  
(Repeat 8 times.)

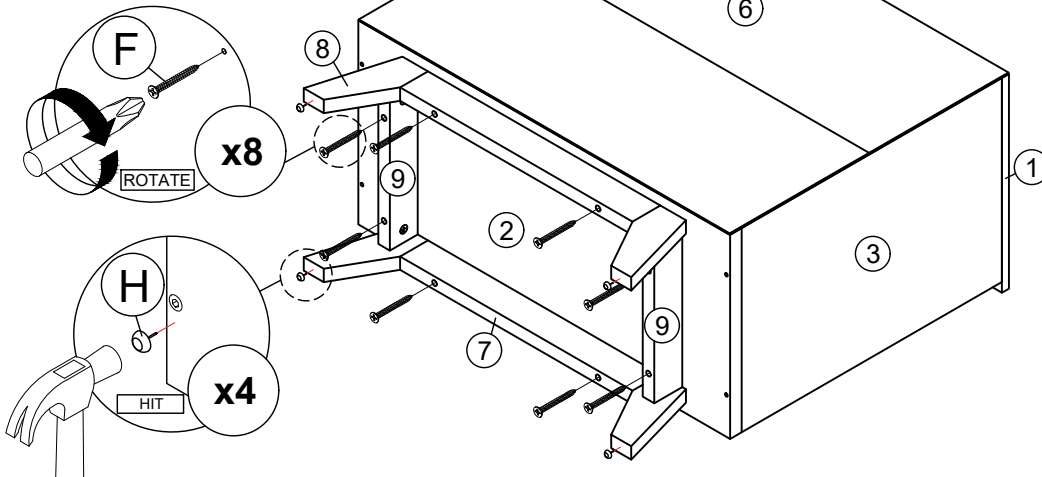

## STEP 10

- Assemble panel **(12)** with panel **(10)** and **(11)** by using hardware **F**.  
(Repeat 24 times.)

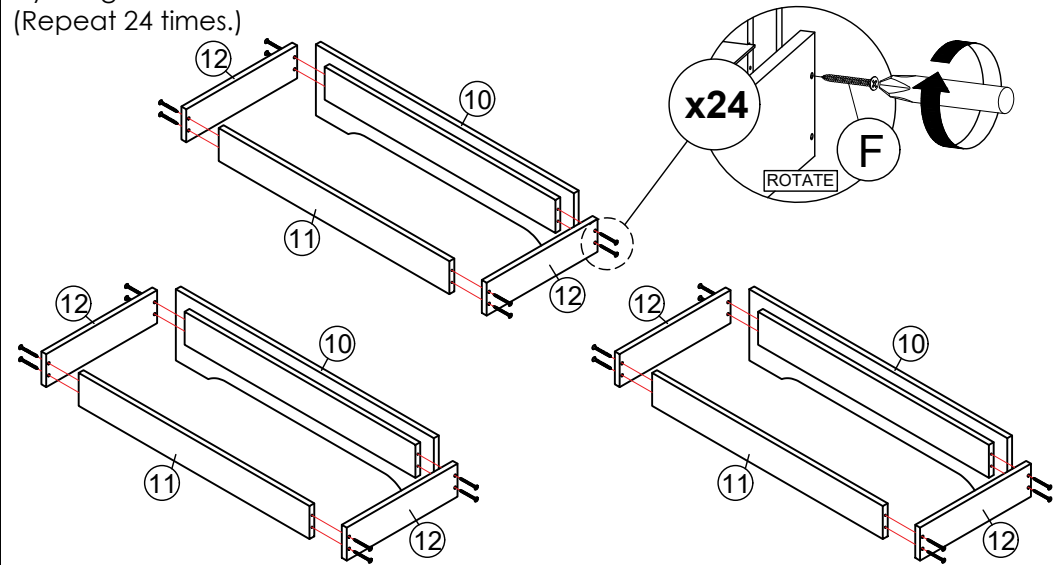

## STEP 11

- Assemble panel **(13)** to entire body with hardware **G**.  
(Repeat 36 times.)

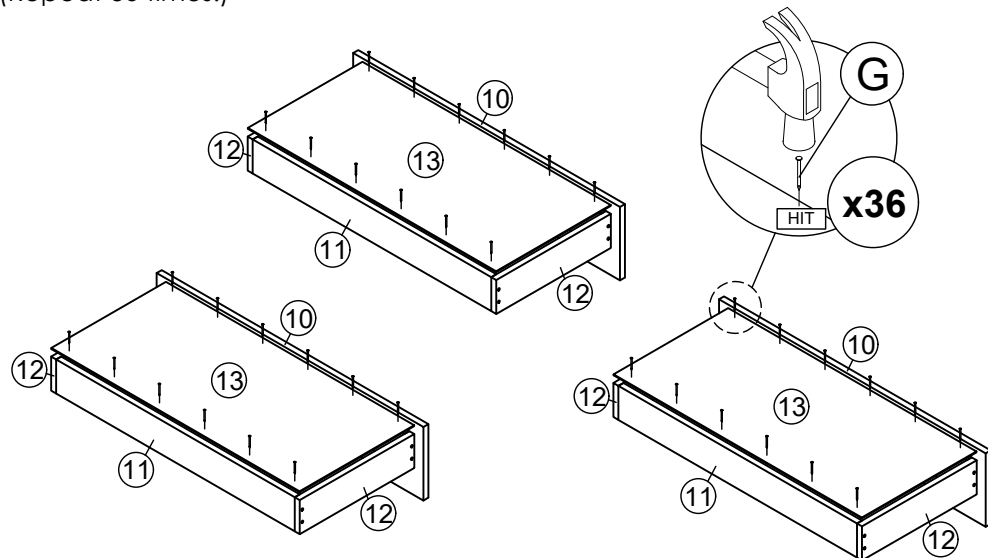

## STEP 12

- Assemble hardware **I2 (L/R)** to panel **(13)** by using hardware **E**.  
(Repeat 3 times for each hardware.)

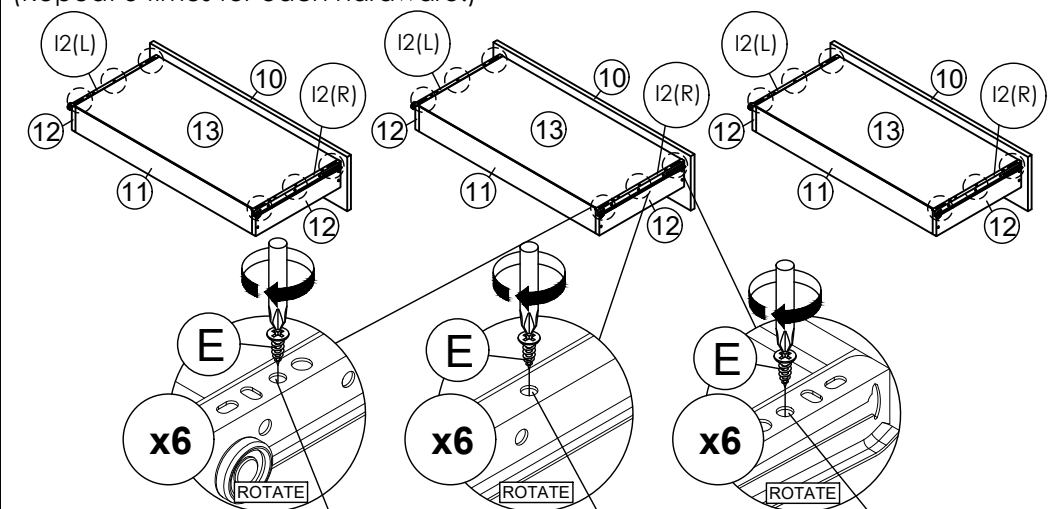

Third hole from the edge. Hole at the center. Third hole from the edge.

\*Hardware **I2 (L/R)** shall be leaning against panel **(10)** when assembling.

## STEP 13

Put all the drawer in place along the drawer slides.

